

Projection:
 Modified Transverse Mercator (10TM)
 False Easting: 0.000 E
 False Northing: 0.000 N
 Central Meridian: 115° W
 Scale Factor: 0.9992
 North American Datum of 1983 (NAD83)

Data Source:
 AltaLIS (<http://www.altalis.com>)

Drawn: Aug 20th, 2004

\\...\\mxd\\map_booklets\\zoning



Town of Drayton Valley Zoning Map



The information provided within this map is provided in good faith for the interest and convenience of the public. The Town of Drayton Valley makes no representation as to the completeness, timeliness and accuracy of the information contained within this map. Users should confirm all information before making decisions based upon it.

Author:
 Ryan Edwards
 GIS Administrator

The Town of Drayton Valley
 5120 - 52nd Street
 Box 6837 T7A 1A1
 Phone: (780) 514 - 2200
 Fax: (780) 542 - 5753

gis@town.draytonvalley.ab.ca
<http://www.town.draytonvalley.ab.ca>

Revised October 3rd, 2008

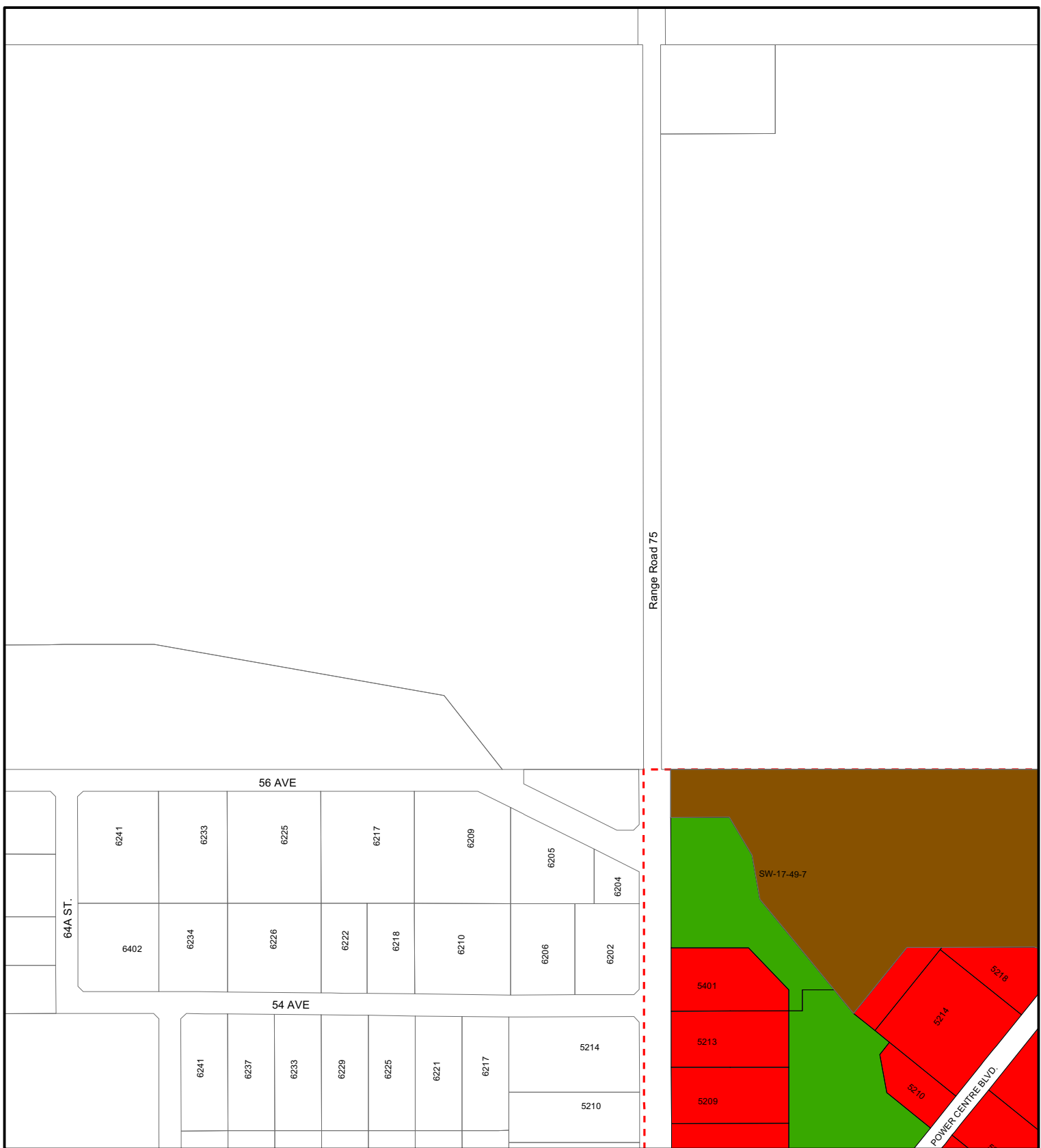

	BE: Entertainment District		R1A: Low Density Residential District		AG-B: Agriculture District - B
	DTDC: Downtown Revitalization Direct Control District		R1B: Standard Residential District		CR: Country Residential District
	DC: Direct Control		R1N: Low Density Narrow Lot Residential District		CRS: Country Residential Suburban Estates District
	C1: Central Commercial District		R1E: Estate Residential District		HWY-C: Highway Commercial District
	C2: General Commercial District		R1Z: Zero Lot Line Residential District		Ri: Rural Industrial District
	M: Industrial District		R2: General Residential District		
	IPU: Institutional and Public Uses District		R3: Medium Density Residential District		
	WVP: West Valley Park District		R4: High Density Residential District		
	UX: Urban Expansion District		RMP: Manufactured Housing Park District		
			RMS: Manufactured Housing Subdivision District		



**Town of Drayton Valley
Land Use District Map**

ByLaw No. 2007-24-D

Annexed Lands*
Lands acquired from Brazeau County January 1, 2002. *Brazeau County LUB #368-99 (including amendments) applies to these lands until Dec. 31st, 2010 unless otherwise indicated in the Annexation Order.

The information provided within this map is provided in good faith for the interest and convenience of the public. The Town of Drayton Valley makes no representation as to the completeness, timeliness and accuracy of the information contained within this map. Users should confirm all information before making decisions based upon it.

Revised: October 3rd, 2008

\\...\\mxd\base\LUB 2007-24-D (36x48).mxd

Scale: 1:5,000

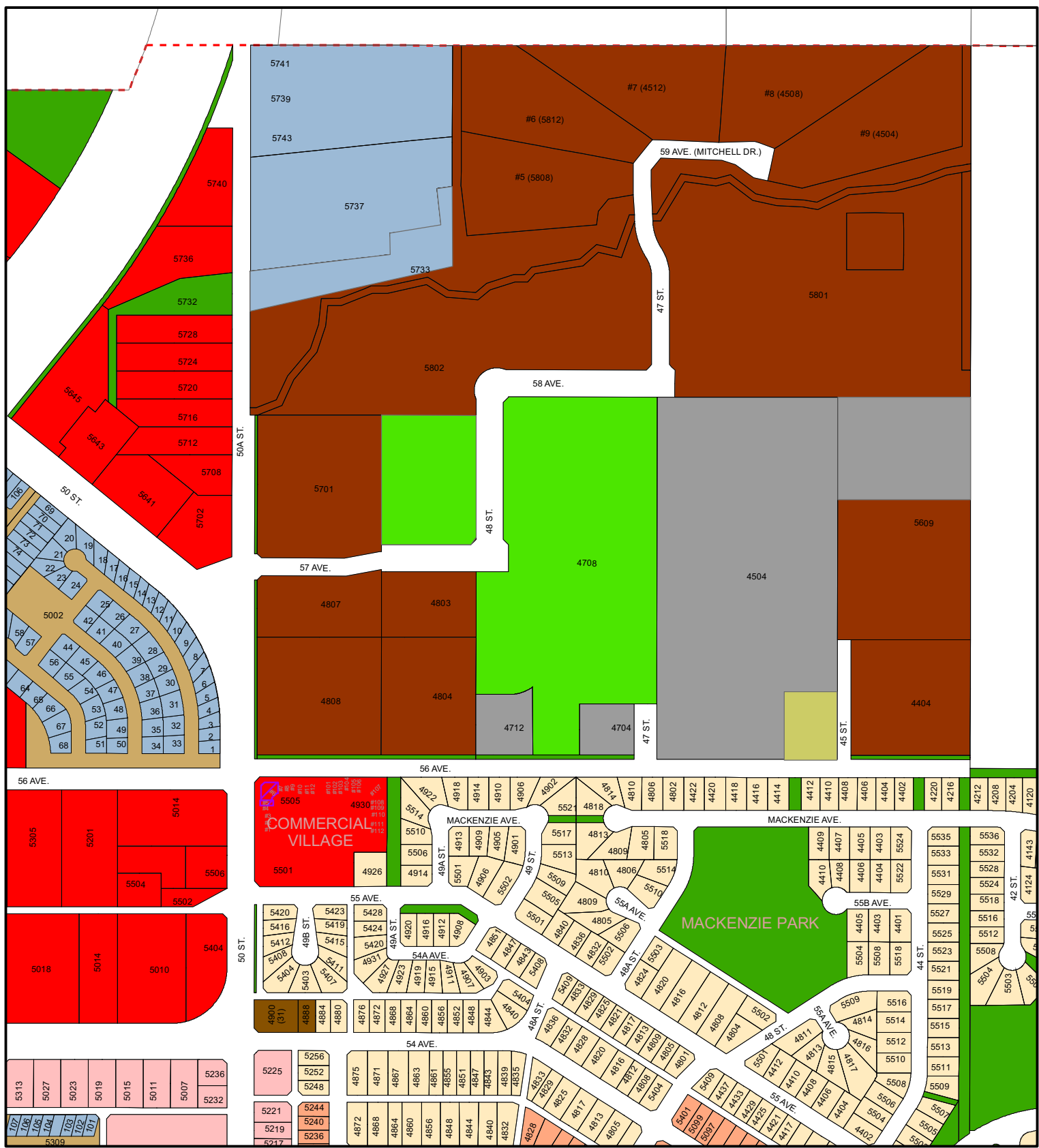

- BE: Entertainment District
- DTDC: Downtown Revitalization Direct Control District
- DC: Direct Control
- C1: Central Commercial District
- C2: General Commercial District
- M: Industrial District
- IPU: Institutional and Public Uses District
- WVP: West Valley Park District
- UX: Urban Expansion District

- R1A: Low Density Residential District
- R1B: Standard Residential District
- R1N: Low Density Narrow Lot Residential District
- R1E: Estate Residential District
- R1Z: Zero Lot Line Residential District
- R2: General Residential District
- R3: Medium Density Residential District
- R4: High Density Residential District
- RMP: Manufactured Housing Park District
- RMS: Manufactured Housing Subdivision District

- Annexed Lands (Brazeau County LUB #968-99)**
- AG-B: Agriculture District - B
 - CR: Country Residential District
 - CRS: Country Residential Suburban Estates District
 - HWY-C: Highway Commercial District
 - RI: Rural Industrial District



**Town of Drayton Valley
Land Use District Map**

ByLaw No. 2007-24-D

Annexed Lands
Lands acquired from Brazeau County January 1, 2002. Brazeau County LUB #368-99 (including amendments) applies to these lands until Dec. 31st, 2010 unless otherwise indicated in the Annexation Order.

The information provided within this map is provided in good faith for the interest and convenience of the public. The Town of Drayton Valley makes no representation as to the completeness, timeliness and accuracy of the information contained within this map. Users should confirm all information before making decisions based upon it.

Revised: October 3rd, 2008

\\...lmsd\base\LUB 2007-24-D (36x48).mxd

Scale: 1:5,000



Township Road 493

ROADWAY

Range Road 73

5609

5602

5605

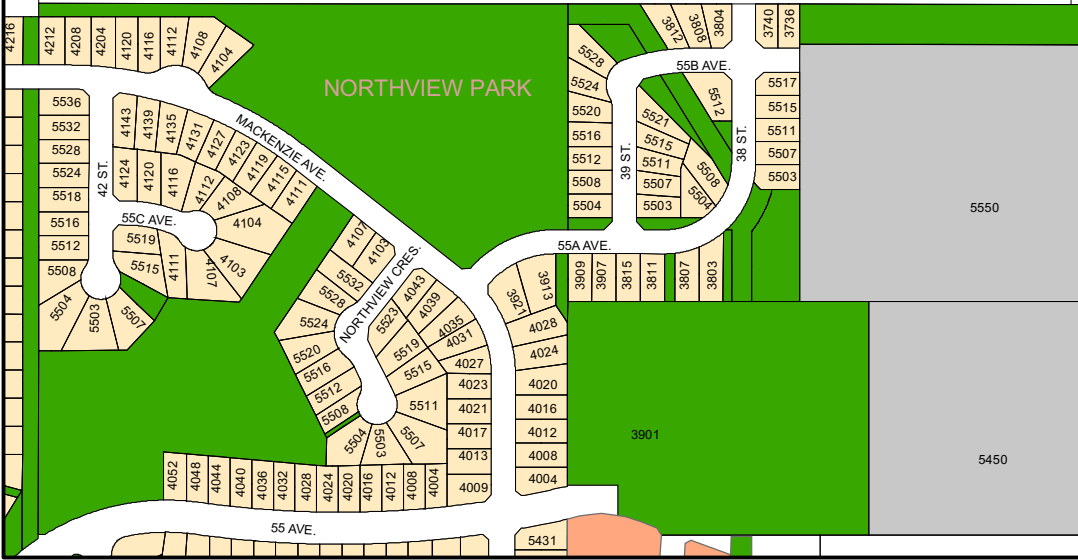

	BE: Entertainment District		R1A: Low Density Residential District		AG-B: Agriculture District - B
	DTDC: Downtown Revitalization Direct Control District		R1B: Standard Residential District		CR: Country Residential District
	DC: Direct Control		R1N: Low Density Narrow Lot Residential District		CRS: Country Residential Suburban Estates District
	C1: Central Commercial District		R1E: Estate Residential District		HWY-C: Highway Commercial District
	C2: General Commercial District		R1Z: Zero Lot Line Residential District		Ri: Rural Industrial District
	M: Industrial District		R2: General Residential District		
	IPU: Institutional and Public Uses District		R3: Medium Density Residential District		
	WVP: West Valley Park District		R4: High Density Residential District		
	UX: Urban Expansion District		RMP: Manufactured Housing Park District		
			RMS: Manufactured Housing Subdivision District		

Annexed Lands (Brazeau County LUB #968-99)



**Town of Drayton Valley
Land Use District Map**

ByLaw No. 2007-24-D

Annexed Lands*
Lands acquired from Brazeau County January 1, 2002. *Brazeau County LUB #368-99 (including amendments) applies to these lands until Dec. 31st, 2010 unless otherwise indicated in the Annexation Order.

The information provided within this map is provided in good faith for the interest and convenience of the public. The Town of Drayton Valley makes no representation as to the completeness, timeliness and accuracy of the information contained within this map. Users should confirm all information before making decisions based upon it.

Revised: October 3rd, 2008

\\...\\mxd\base\LUB 2007-24-D (36x48).mxd

Scale: 1:5,000



	BE: Entertainment District		R1A: Low Density Residential District		AG-B: Agriculture District - B
	DTDC: Downtown Revitalization Direct Control District		R1B: Standard Residential District		CR: Country Residential District
	DC: Direct Control		R1N: Low Density Narrow Lot Residential District		CRS: Country Residential Suburban Estates District
	C1: Central Commercial District		R1E: Estate Residential District		HWY-C: Highway Commercial District
	C2: General Commercial District		R1Z: Zero Lot Line Residential District		Ri: Rural Industrial District
	M: Industrial District		R2: General Residential District		
	IPU: Institutional and Public Uses District		R3: Medium Density Residential District		
	WVP: West Valley Park District		R4: High Density Residential District		
	UX: Urban Expansion District		RMP: Manufactured Housing Park District		
			RMS: Manufactured Housing Subdivision District		



**Town of Drayton Valley
Land Use District Map**

ByLaw No. 2007-24-D

Annexed Lands
Lands acquired from Brazeau County January 1, 2002. Brazeau County LUB #368-99 (including amendments) applies to these lands until Dec. 31st, 2010 unless otherwise indicated in the Annexation Order.

The information provided within this map is provided in good faith for the interest and convenience of the public. The Town of Drayton Valley makes no representation as to the completeness, timeliness and accuracy of the information contained within this map. Users should confirm all information before making decisions based upon it.

Revised: October 3rd, 2008

\\...\\mxd\base\LUB 2007-24-D (36x48).mxd

Scale: 1:5,000



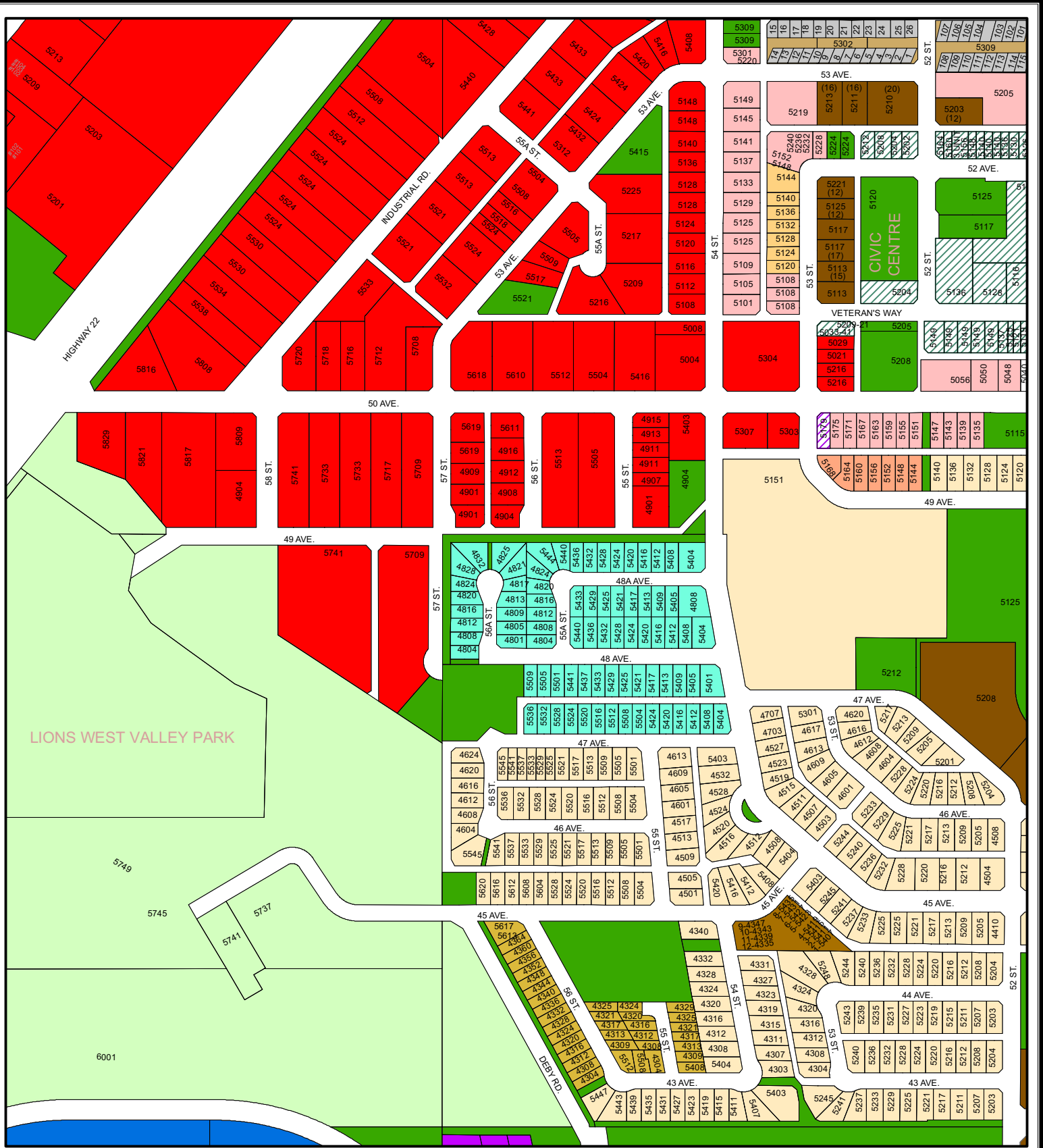

	BE: Entertainment District		R1A: Low Density Residential District		AG-B: Agriculture District - B
	DTDC: Downtown Revitalization Direct Control District		R1B: Standard Residential District		CR: Country Residential District
	DC: Direct Control		R1N: Low Density Narrow Lot Residential District		CRS: Country Residential Suburban Estates District
	C1: Central Commercial District		R1E: Estate Residential District		HWY-C: Highway Commercial District
	C2: General Commercial District		R12: Zero Lot Line Residential District		Ri: Rural Industrial District
	M: Industrial District		R2: General Residential District		
	IPU: Institutional and Public Uses District		R3: Medium Density Residential District		
	WVP: West Valley Park District		R4: High Density Residential District		
	UX: Urban Expansion District		RMP: Manufactured Housing Park District		
			RMS: Manufactured Housing Subdivision District		

Town of Drayton Valley
Land Use District Map

ByLaw No. 2007-24-D

Annexed Lands
Lands acquired from Brazeau County January 1, 2002. Brazeau County LUB #368-99 (including amendments) applies to these lands until Dec. 31st, 2010 unless otherwise indicated in the Annexation Order.

The information provided within this map is provided in good faith for the interest and convenience of the public. The Town of Drayton Valley makes no representation as to the completeness, timeliness and accuracy of the information contained within this map. Users should confirm all information before making decisions based upon it.

Revised: October 3rd, 2008
 \\...mxd\base\LUB 2007-24-D (36x48).mxd
 Scale: 1:5,000



	BE: Entertainment District		R1A: Low Density Residential District		AG-B: Agriculture District - B
	DTDC: Downtown Revitalization Direct Control District		R1B: Standard Residential District		CR: Country Residential District
	DC: Direct Control		R1N: Low Density Narrow Lot Residential District		CRS: Country Residential Suburban Estates District
	C1: Central Commercial District		R1E: Estate Residential District		HWY-C: Highway Commercial District
	C2: General Commercial District		R1Z: Zero Lot Line Residential District		RI: Rural Industrial District
	M: Industrial District		R2: General Residential District		
	IPU: Institutional and Public Uses District		R3: Medium Density Residential District		
	WVP: West Valley Park District		R4: High Density Residential District		
	UX: Urban Expansion District		RMP: Manufactured Housing Park District		
			RMS: Manufactured Housing Subdivision District		



**Town of Drayton Valley
Land Use District Map**

ByLaw No. 2007-24-D

Annexed Lands
Lands acquired from Brazeau County January 1, 2002. Brazeau County LUB #368-99 (including amendments) applies to these lands until Dec. 31st, 2010 unless otherwise indicated in the Annexation Order.

The information provided within this map is provided in good faith for the interest and convenience of the public. The Town of Drayton Valley makes no representation as to the completeness, timeliness and accuracy of the information contained within this map. Users should confirm all information before making decisions based upon it.

Revised: October 3rd, 2008

\\...lmsd\base\LUB 2007-24-D (36x48).mxd

Scale: 1:5,000



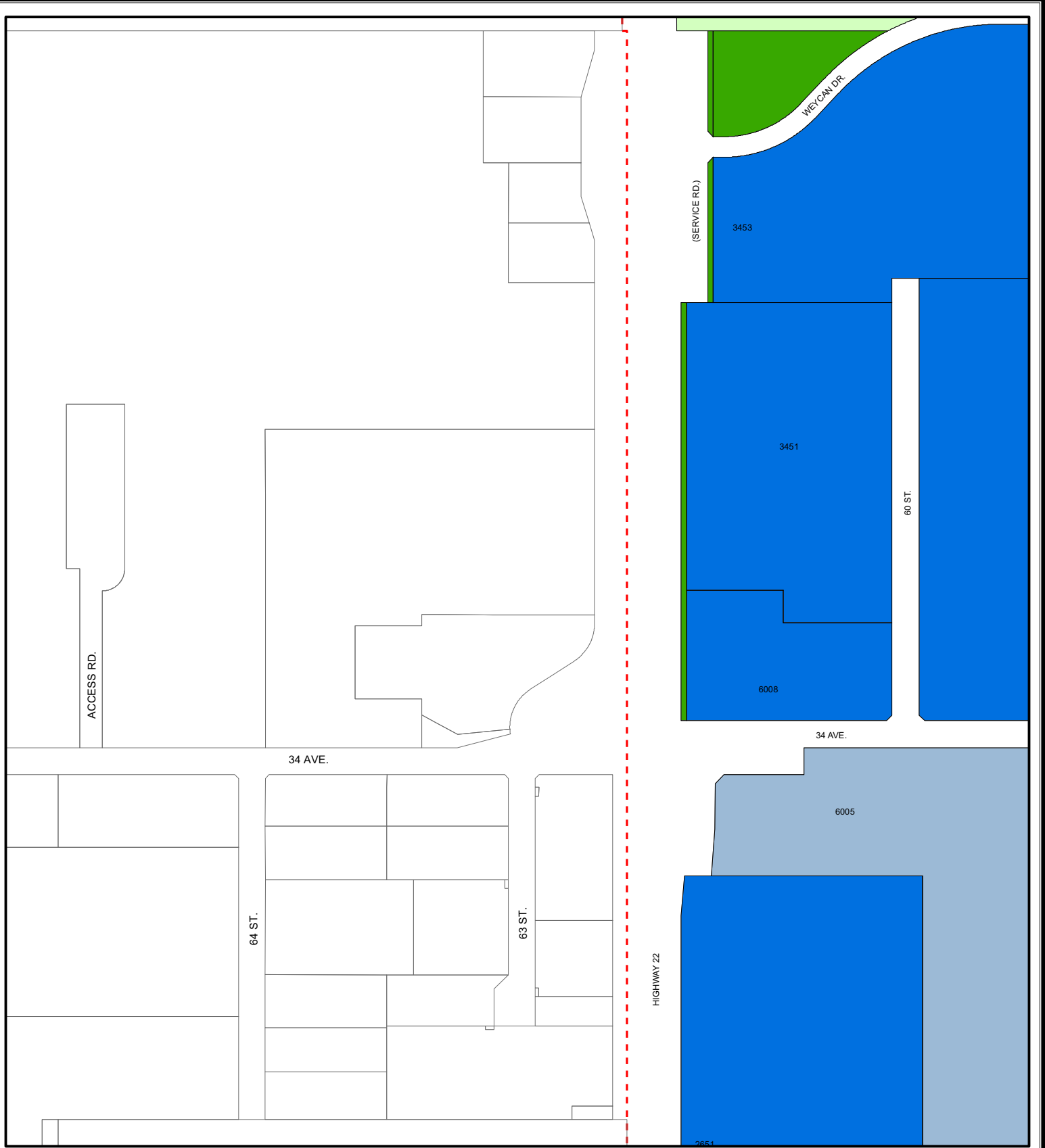

	BE: Entertainment District		R1A: Low Density Residential District		AG-B: Agriculture District - B
	DTDC: Downtown Revitalization Direct Control District		R1B: Standard Residential District		CR: Country Residential District
	DC: Direct Control		R1N: Low Density Narrow Lot Residential District		CRS: Country Residential Suburban Estates District
	C1: Central Commercial District		R1E: Estate Residential District		HWY-C: Highway Commercial District
	C2: General Commercial District		R1Z: Zero Lot Line Residential District		RI: Rural Industrial District
	M: Industrial District		R2: General Residential District		
	IPU: Institutional and Public Uses District		R3: Medium Density Residential District		
	WVP: West Valley Park District		R4: High Density Residential District		
	UX: Urban Expansion District		RMP: Manufactured Housing Park District		
			RMS: Manufactured Housing Subdivision District		



Town of Drayton Valley
Land Use District Map
ByLaw No. 2007-24-D

Annexed Lands*
Lands acquired from Brazeau County January 1, 2002. *Brazeau County LUB #368-99 (including amendments) applies to these lands until Dec. 31st, 2010 unless otherwise indicated in the Annexation Order.

The information provided within this map is provided in good faith for the interest and convenience of the public. The Town of Drayton Valley makes no representation as to the completeness, timeliness and accuracy of the information contained within this map. Users should confirm all information before making decisions based upon it.

Revised: October 3rd, 2008
 \\...\\mxd\base\LUB 2007-24-D (36x48).mxd Scale: 1:5,000



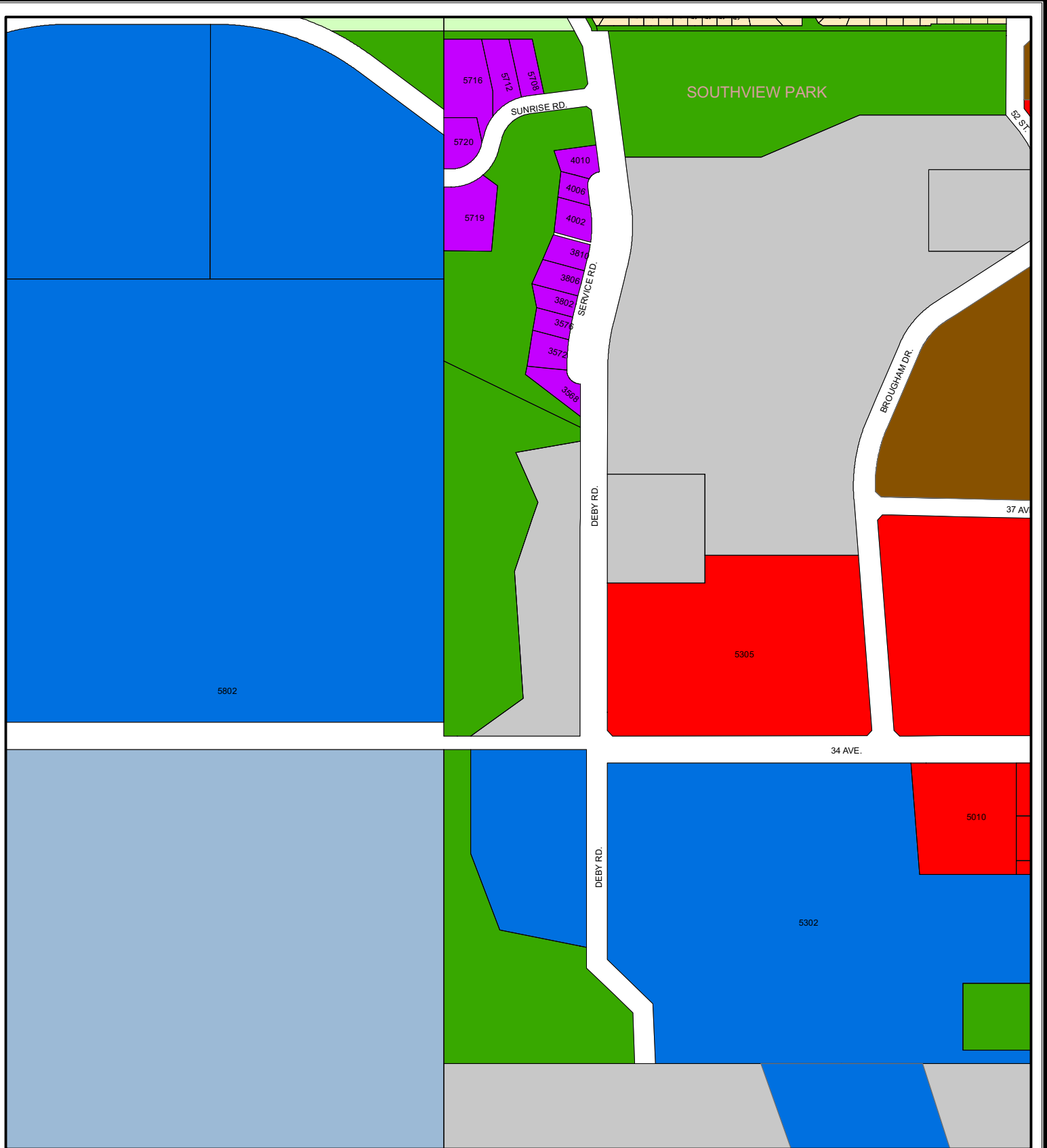

	BE: Entertainment District		R1A: Low Density Residential District		AG-B: Agriculture District - B
	DTDC: Downtown Revitalization Direct Control District		R1B: Standard Residential District		CR: Country Residential District
	DC: Direct Control		R1N: Low Density Narrow Lot Residential District		CRS: Country Residential Suburban Estates District
	C1: Central Commercial District		R1E: Estate Residential District		HWY-C: Highway Commercial District
	C2: General Commercial District		R1Z: Zero Lot Line Residential District		Ri: Rural Industrial District
	M: Industrial District		R2: General Residential District		
	IPU: Institutional and Public Uses District		R3: Medium Density Residential District		
	WVP: West Valley Park District		R4: High Density Residential District		
	UX: Urban Expansion District		RMP: Manufactured Housing Park District		
			RMS: Manufactured Housing Subdivision District		



**Town of Drayton Valley
Land Use District Map**

ByLaw No. 2007-24-D

Annexed Lands*
Lands acquired from Brazeau County January 1, 2002. *Brazeau County LUB #368-99 (including amendments) applies to these lands until Dec. 31st, 2010 unless otherwise indicated in the Annexation Order.

The information provided within this map is provided in good faith for the interest and convenience of the public. The Town of Drayton Valley makes no representation as to the completeness, timeliness and accuracy of the information contained within this map. Users should confirm all information before making decisions based upon it.

Revised: October 3rd, 2008

\\...lmsd\base\LUB 2007-24-D (36x48).mxd

Scale: 1:5,000



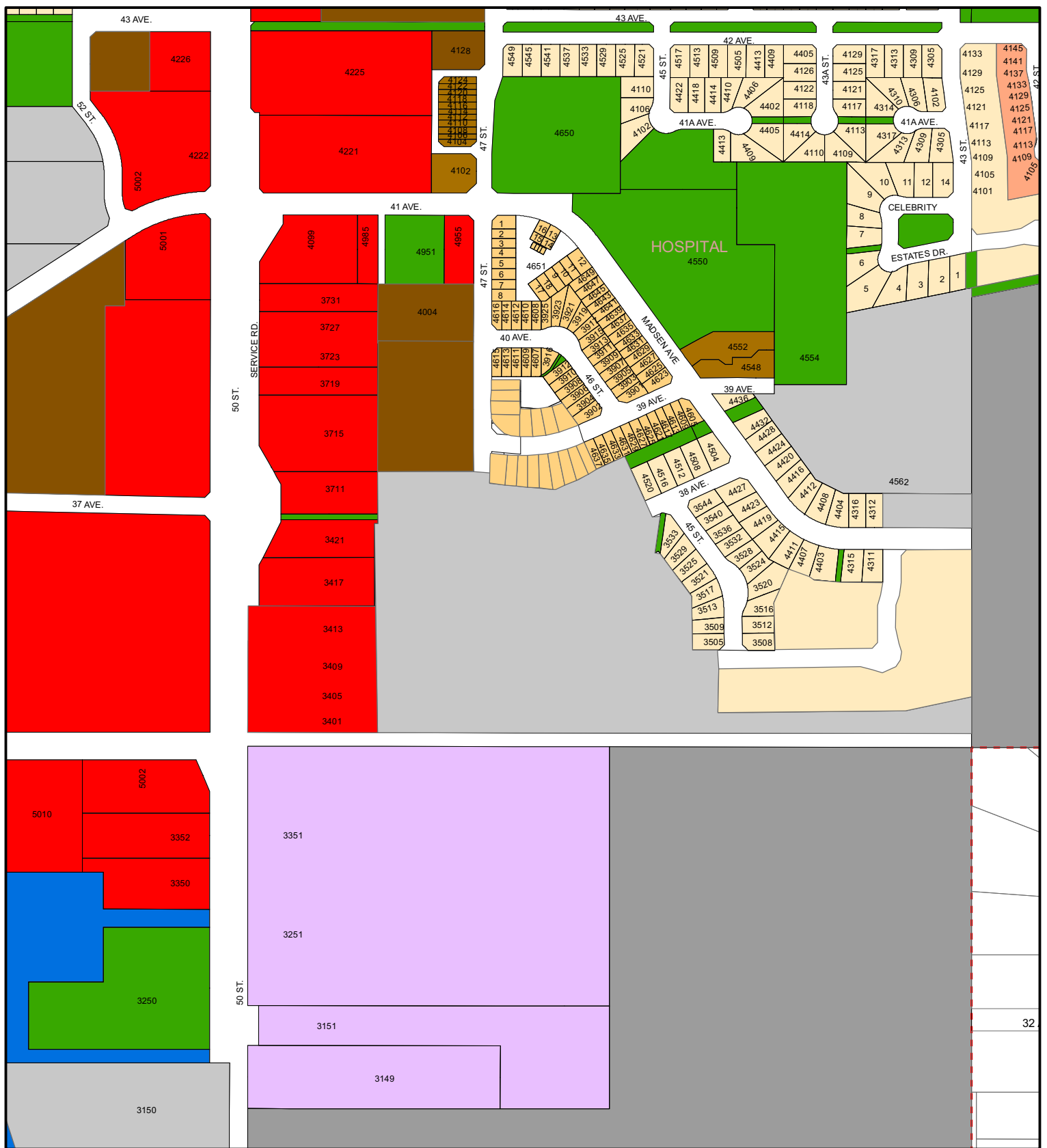

	BE: Entertainment District		R1A: Low Density Residential District		AG-B: Agriculture District - B
	DTDC: Downtown Revitalization Direct Control District		R1B: Standard Residential District		CR: Country Residential District
	DC: Direct Control		R1N: Low Density Narrow Lot Residential District		CRS: Country Residential Suburban Estates District
	C1: Central Commercial District		R1E: Estate Residential District		HWY-C: Highway Commercial District
	C2: General Commercial District		R1Z: Zero Lot Line Residential District		Ri: Rural Industrial District
	M: Industrial District		R2: General Residential District		
	IPU: Institutional and Public Uses District		R3: Medium Density Residential District		
	WVP: West Valley Park District		R4: High Density Residential District		
	UX: Urban Expansion District		RMP: Manufactured Housing Park District		
			RMS: Manufactured Housing Subdivision District		



Town of Drayton Valley
Land Use District Map

ByLaw No. 2007-24-D

Annexed Lands*
Lands acquired from Brazeau County January 1, 2002. *Brazeau County LUB #368-99 (including amendments) applies to these lands until Dec. 31st, 2010 unless otherwise indicated in the Annexation Order.

The information provided within this map is provided in good faith for the interest and convenience of the public. The Town of Drayton Valley makes no representation as to the completeness, timeliness and accuracy of the information contained within this map. Users should confirm all information before making decisions based upon it.

Revised: October 3rd, 2008
 \\...lmsd\base\LUB 2007-24-D (36x48).mxd Scale: 1:5,000

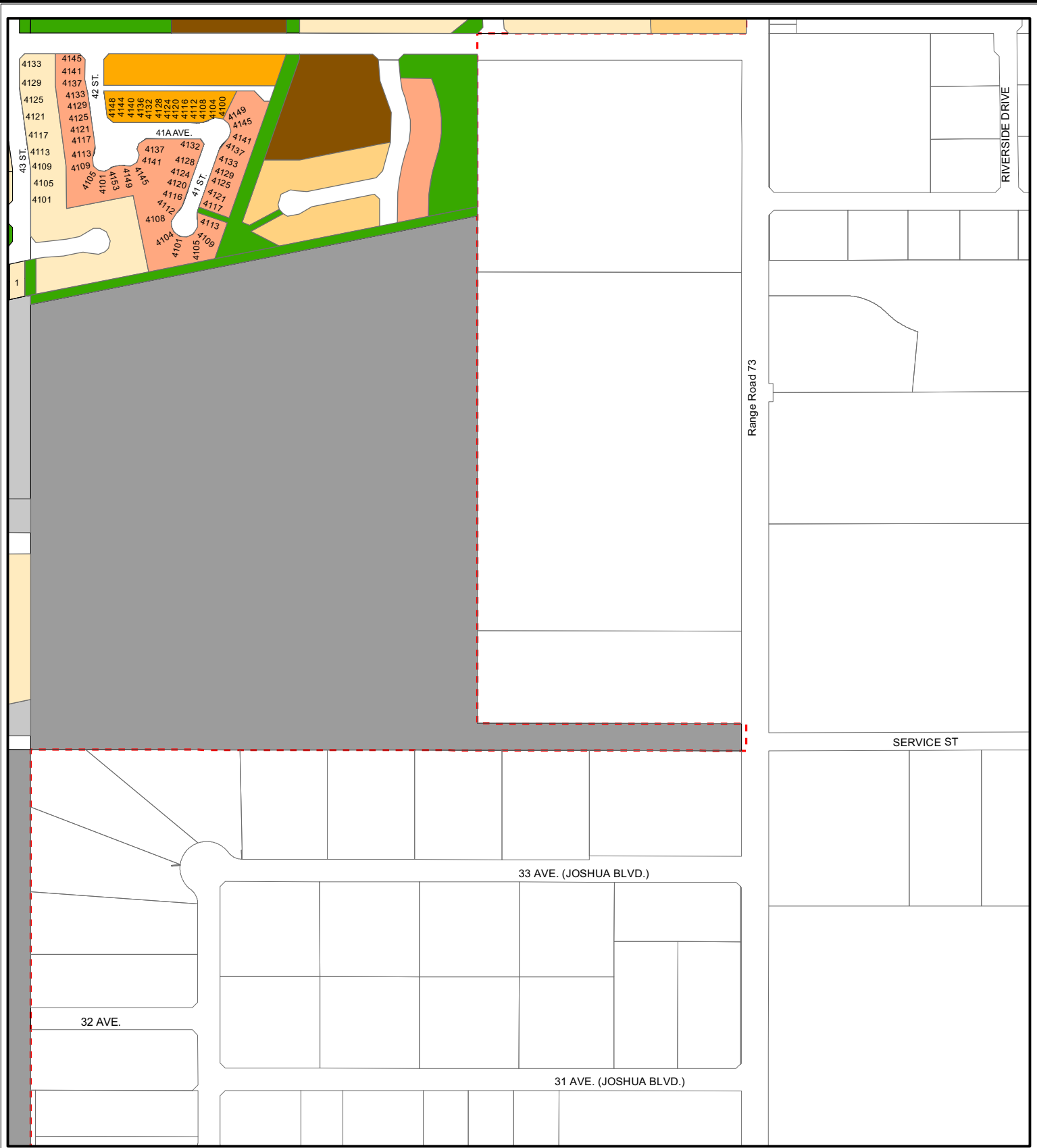

	BE: Entertainment District		R1A: Low Density Residential District		AG-B: Agriculture District - B
	DTDC: Downtown Revitalization Direct Control District		R1B: Standard Residential District		CR: Country Residential District
	DC: Direct Control		R1N: Low Density Narrow Lot Residential District		CRS: Country Residential Suburban Estates District
	C1: Central Commercial District		R1E: Estate Residential District		HWY-C: Highway Commercial District
	C2: General Commercial District		R1Z: Zero Lot Line Residential District		Ri: Rural Industrial District
	M: Industrial District		R2: General Residential District		
	IPU: Institutional and Public Uses District		R3: Medium Density Residential District		
	WVP: West Valley Park District		R4: High Density Residential District		
	UX: Urban Expansion District		RMP: Manufactured Housing Park District		
			RMS: Manufactured Housing Subdivision District		



**Town of Drayton Valley
Land Use District Map**

ByLaw No. 2007-24-D

Annexed Lands*
Lands acquired from Brazeau County January 1, 2002. *Brazeau County LUB #368-99 (including amendments) applies to these lands until Dec. 31st, 2010 unless otherwise indicated in the Annexation Order.

The information provided within this map is provided in good faith for the interest and convenience of the public. The Town of Drayton Valley makes no representation as to the completeness, timeliness and accuracy of the information contained within this map. Users should confirm all information before making decisions based upon it.









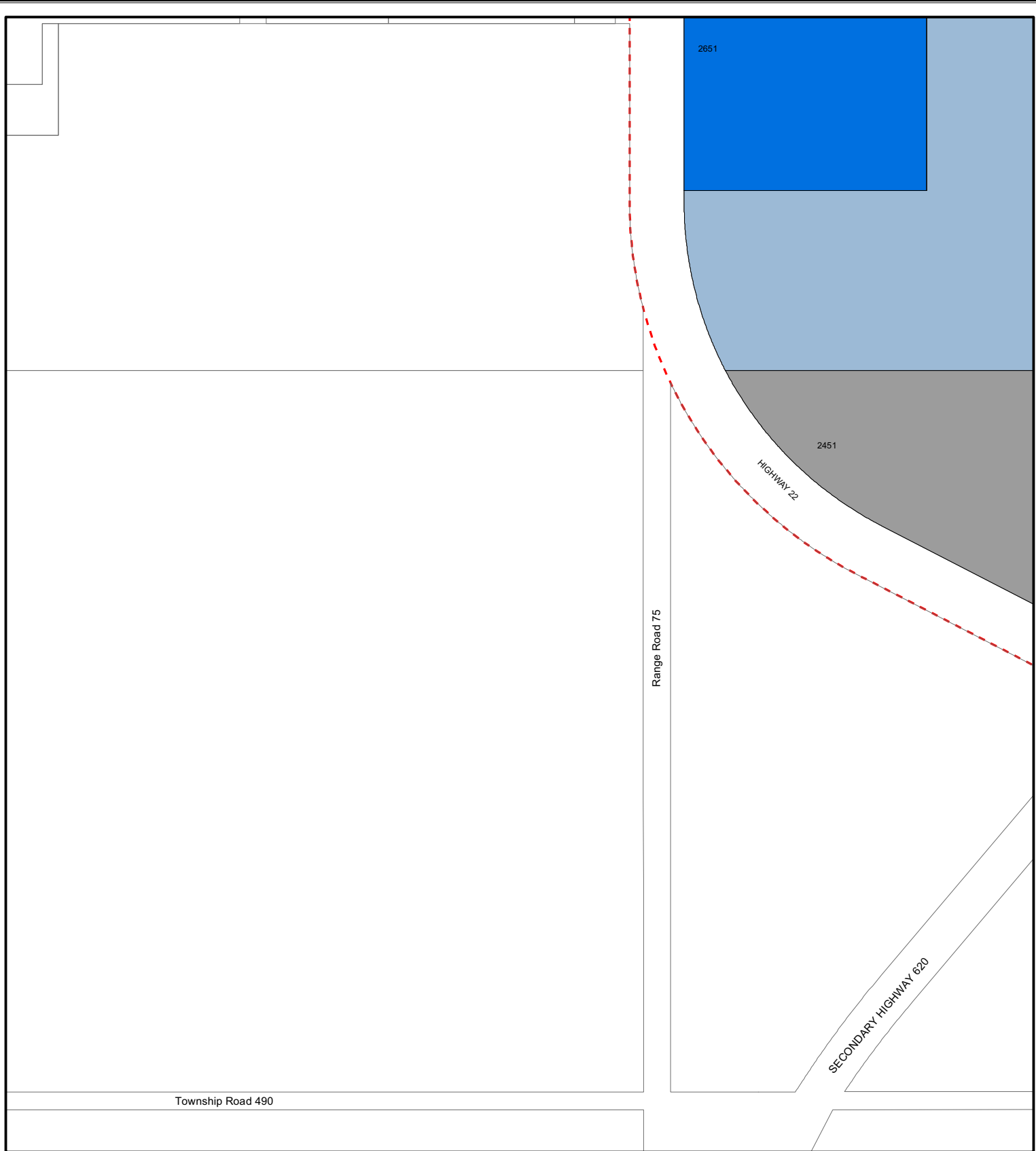







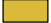



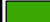

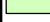
Revised: October 3rd, 2008

\\...mxd\base\LUB 2007-24-D (36x48).mxd

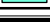
Scale: 1:5,000





 BE: Entertainment District	 R1A: Low Density Residential District	
 DTDC: Downtown Revitalization Direct Control District	 R1B: Standard Residential District	
 DC: Direct Control	 R1N: Low Density Narrow Lot Residential District	
 C1: Central Commercial District	 R1E: Estate Residential District	Annexed Lands (Brazeau County LUB #968-99)
 C2: General Commercial District	 R1Z: Zero Lot Line Residential District	 AG-B: Agriculture District - B
 M: Industrial District	 R2: General Residential District	 CR: Country Residential District
 IPU: Institutional and Public Uses District	 R3: Medium Density Residential District	 CRS: Country Residential Suburban Estates District
 WVP: West Valley Park District	 R4: High Density Residential District	 HWY-C: Highway Commercial District
 UX: Urban Expansion District	 RMP: Manufactured Housing Park District	 RI: Rural Industrial District
	 RMS: Manufactured Housing Subdivision District	



**Town of Drayton Valley
Land Use District Map**

ByLaw No. 2007-24-D

Annexed Lands
Lands acquired from Brazeau County January 1, 2002. Brazeau County LUB #368-99 (including amendments) applies to these lands until Dec. 31st, 2010 unless otherwise indicated in the Annexation Order.

The information provided within this map is provided in good faith for the interest and convenience of the public. The Town of Drayton Valley makes no representation as to the completeness, timeliness and accuracy of the information contained within this map. Users should confirm all information before making decisions based upon it.

Revised: October 3rd, 2008

\\...mxd\base\LUB 2007-24-D (36x48).mxd

Scale: 1:5,000



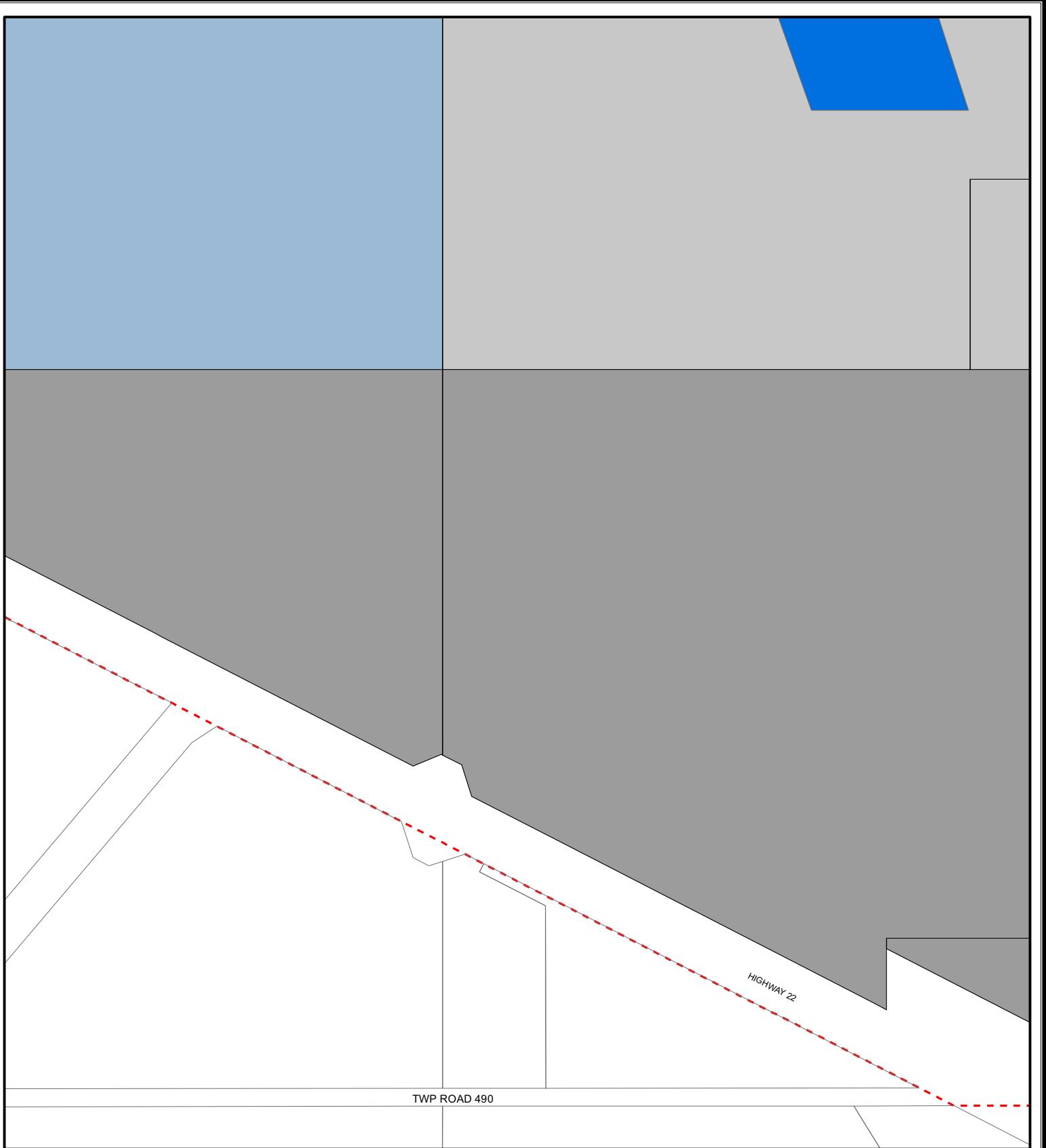

	BE: Entertainment District		R1A: Low Density Residential District		Annexed Lands (Brazeau County LUB #968-99)
	DTDC: Downtown Revitalization Direct Control District		R1B: Standard Residential District		AG-B: Agriculture District - B
	DC: Direct Control		R1N: Low Density Narrow Lot Residential District		CR: Country Residential District
	C1: Central Commercial District		R1E: Estate Residential District		CRS: Country Residential Suburban Estates District
	C2: General Commercial District		R1Z: Zero Lot Line Residential District		HWY-C: Highway Commercial District
	M: Industrial District		R2: General Residential District		Ri: Rural Industrial District
	IPU: Institutional and Public Uses District		R3: Medium Density Residential District		
	WVP: West Valley Park District		R4: High Density Residential District		
	UX: Urban Expansion District		RMP: Manufactured Housing Park District		
			RMS: Manufactured Housing Subdivision District		



Town of Drayton Valley
Land Use District Map

ByLaw No. 2007-24-D



Annexed Lands*
Lands acquired from Brazeau County January 1, 2002. *Brazeau County LUB #368-99 (including amendments) applies to these lands until Dec. 31st, 2010 unless otherwise indicated in the Annexation Order.

The information provided within this map is provided in good faith for the interest and convenience of the public. The Town of Drayton Valley makes no representation as to the completeness, timeliness and accuracy of the information contained within this map. Users should confirm all information before making decisions based upon it.

Revised: October 3rd, 2008
 \\...mxd\base\LUB 2007-24-D (36x48).mxd Scale: 1:5,000

21

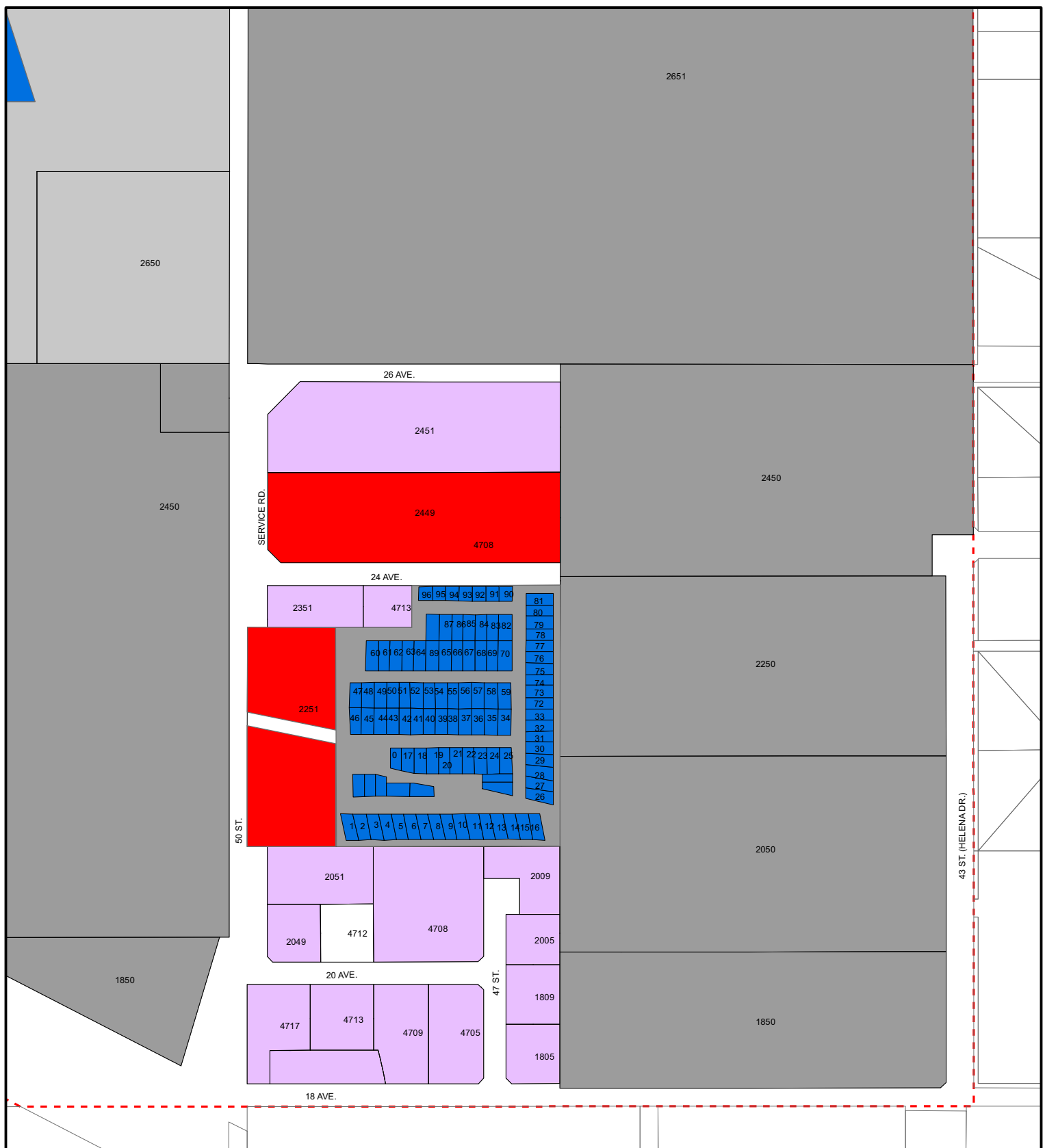

	BE: Entertainment District		R1A: Low Density Residential District		AG-B: Agriculture District - B
	DTDC: Downtown Revitalization Direct Control District		R1B: Standard Residential District		CR: Country Residential District
	DC: Direct Control		R1N: Low Density Narrow Lot Residential District		CRS: Country Residential Suburban Estates District
	C1: Central Commercial District		R1E: Estate Residential District		HWY-C: Highway Commercial District
	C2: General Commercial District		R1Z: Zero Lot Line Residential District		Ri: Rural Industrial District
	M: Industrial District		R2: General Residential District		
	IPU: Institutional and Public Uses District		R3: Medium Density Residential District		
	WVP: West Valley Park District		R4: High Density Residential District		
	UX: Urban Expansion District		RMP: Manufactured Housing Park District		
			RMS: Manufactured Housing Subdivision District		



**Town of Drayton Valley
Land Use District Map**

ByLaw No. 2007-24-D

Annexed Lands*
Lands acquired from Brazeau County January 1, 2002. *Brazeau County LUB #368-99 (including amendments) applies to these lands until Dec. 31st, 2010 unless otherwise indicated in the Annexation Order.

The information provided within this map is provided in good faith for the interest and convenience of the public. The Town of Drayton Valley makes no representation as to the completeness, timeliness and accuracy of the information contained within this map. Users should confirm all information before making decisions based upon it.

Revised: October 3rd, 2008

\\...\\mxd\\base\\LUB 2007-24-D (36x48).mxd

Scale: 1:5,000

